

# Twenty

Gresham Street

## EXISTING FIT OUT

13,829 SQ FT (1,285 SQ M)

Workstations	166
6 person meeting rooms	6
Kitchen	1
Comms room	1
<b>Occupancy Total</b>	<b>166</b>

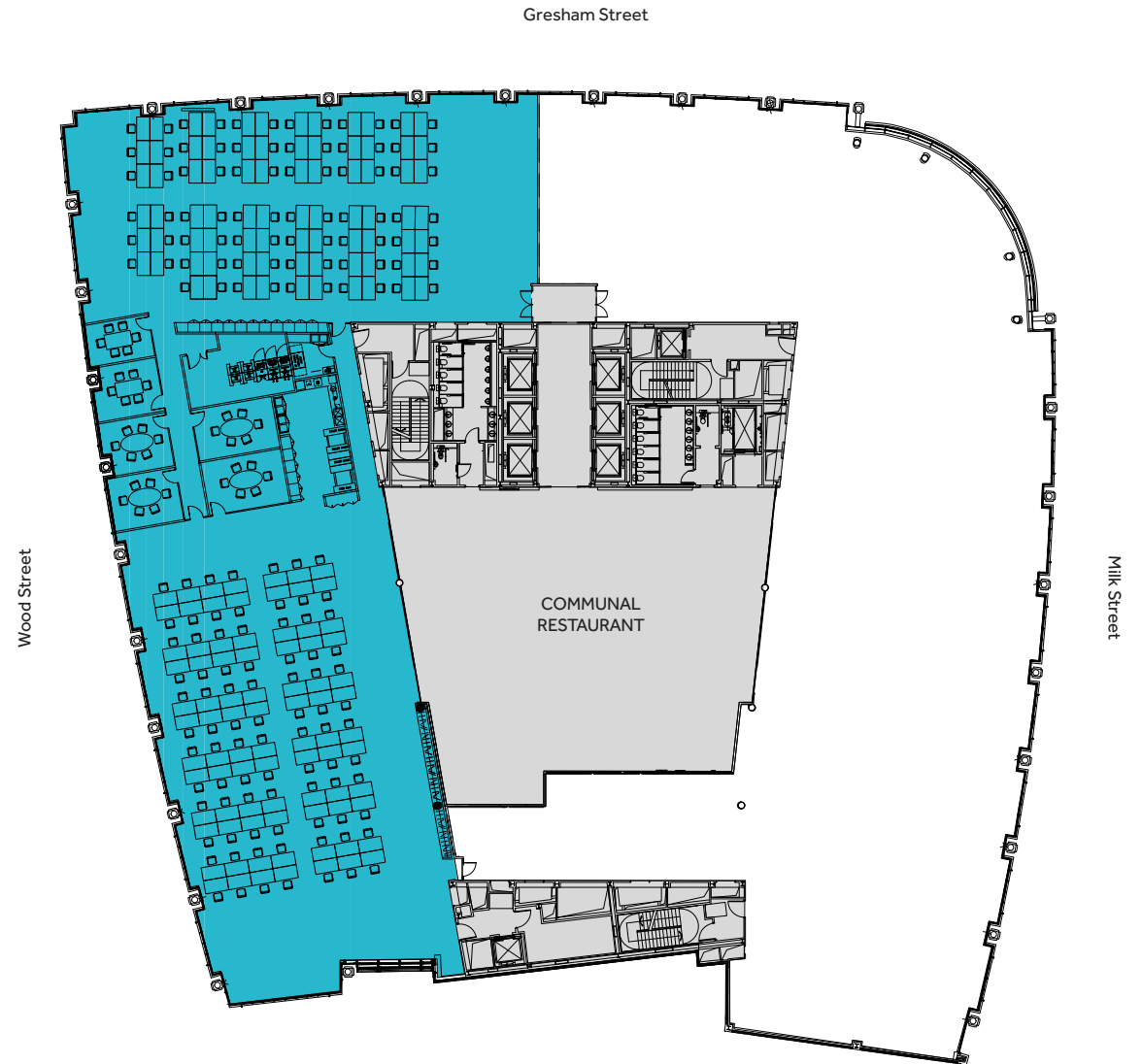

For indicative purposes only - not to scale.

# Twenty

Gresham Street

## CLEAR PLAN

13,829 SQ FT (1,285 SQ M)



For indicative purposes only - not to scale.